



SETIMEP

Engenharia • Ambiente • Energia
Engineering • Environment • Energy

BAG FILTER

MODEL:
SET.FM.DAC.****

PRODUCT DESCRIPTION

The modern industrial processes generate a large amount of atmospheric contamination in various forms: particles, gases, steams and smokes.

When the concentration of gases particles exceeds safe levels, the reduction of these concentrations for legal levels is a crucial feature to the success of a company.

SETIMEP presents a standard Bag filters range dimensioned to reduce the level of pollutant emissions to levels complied with the law.

TYPE OF CONSTRUCTION

Construction in structural carbon steel S235JR
(Manufacturing with specific dimensions and materials on request)



SETIMEP Product
SET

Designation
FM

Serie
DAC

Filtration Area (m²)
0080.....1200

AVAILABLE RANGE

Range designed for the maximum performance and minimization of energetic consumption.

Filtering areas from 80 to 1200 m² (see technical tables).

Universal Applicability and easy maintenance. Could be equipped, on request, with the most varied types of accessories and extraction systems (valves, screw conveyors, etc.).

Dimensions adapted to the customer needs and process varieties (air temperature, nature of the particles, frequency of use, etc.).

CODIFICATION/REFERENCE

SET.FM.DAC.****

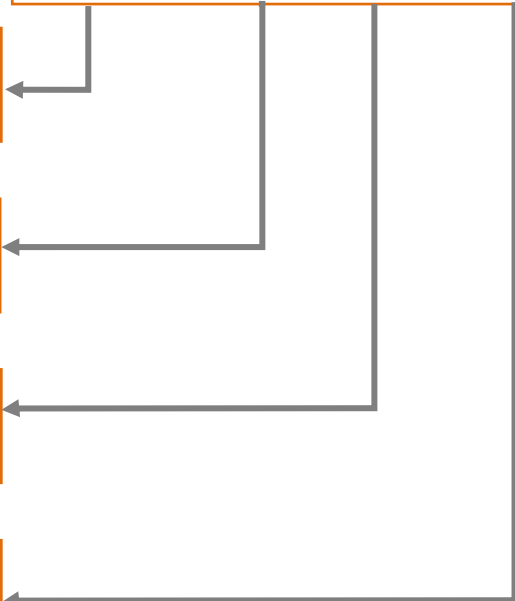

Ex: SET.FM.DAC.0700 → Bag filter with a 700 m² filtering area

ENGENHARIA • AMBIENTE • ENERGIA
ENGINEERING • ENVIRONMENT • ENERGY

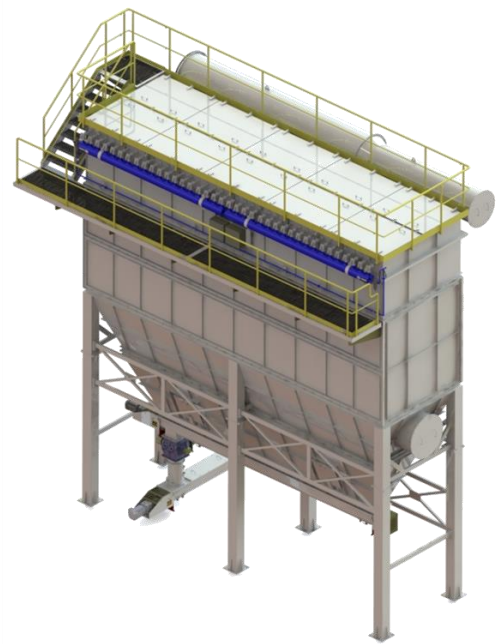

FILTER SELECTION CHART

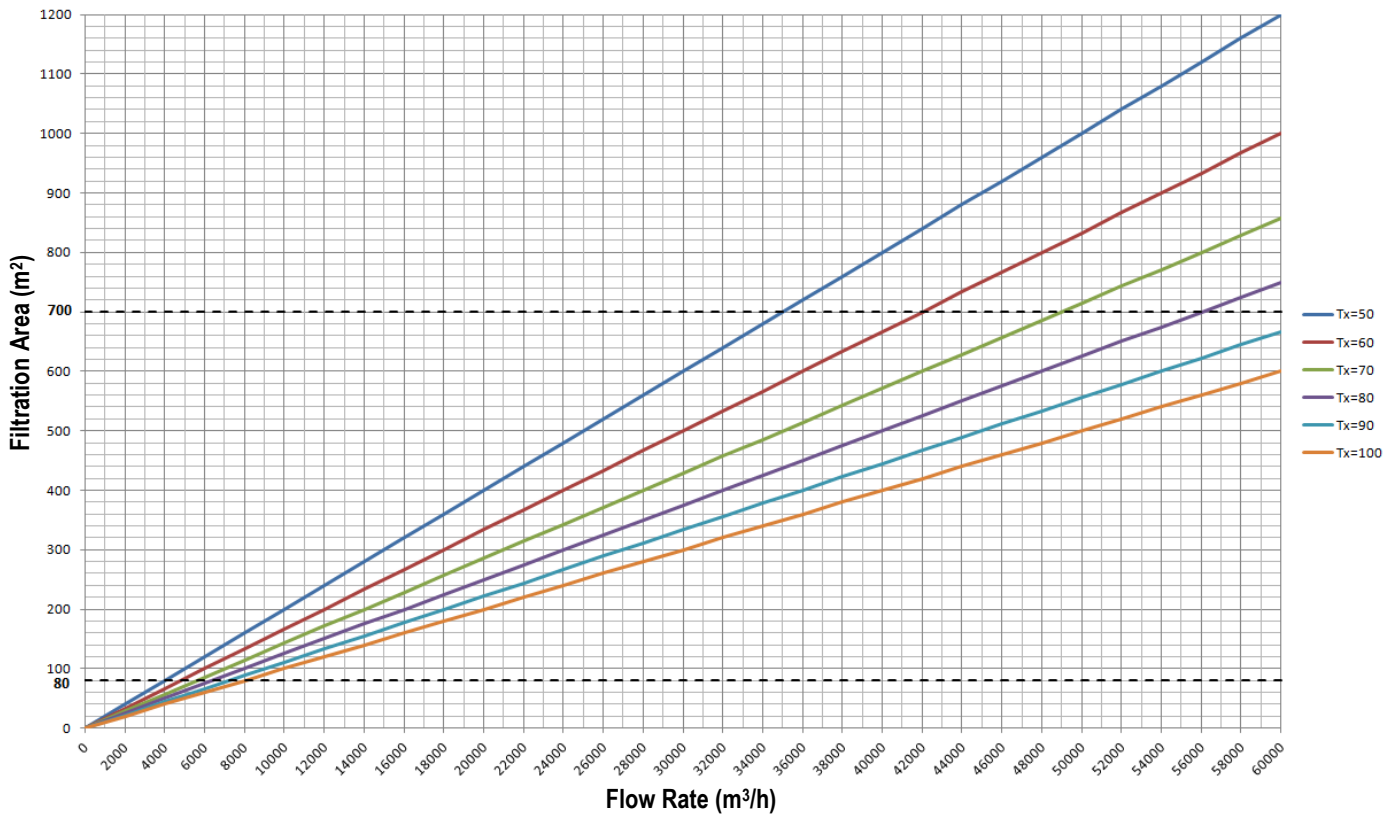

Notes:

The Filtration area required is obtained by crossing the required flow rate with the desired relation of filtration (Tx) and must be standardized using the technical tables presented in the following pages.

Higher Tx → Smaller dimensions filters

Lower Tx → Larger dimensions filters

When the results of the crossing is a value superior or inferior of the chart we recommend analyse other Filters solutions available in www.setimep.com.

Please contact us for additional information.

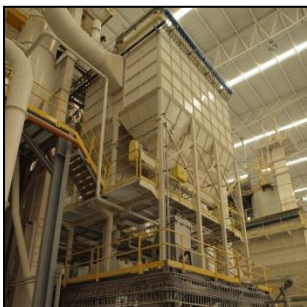

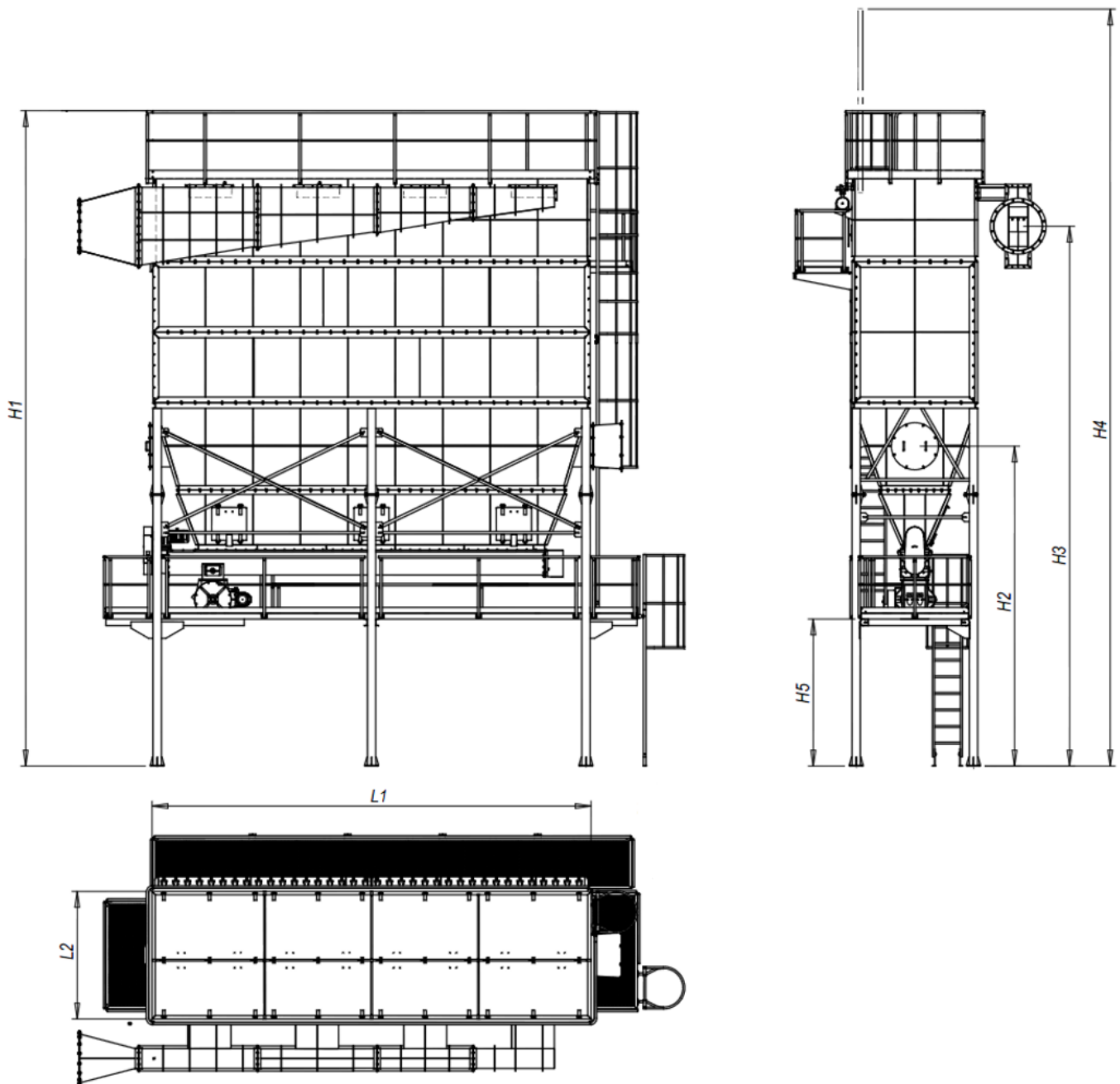

With more than 30 years of experience servicing our clients, national and international (Europe, South America and Africa), our goal is not only compliance with the legislation respecting the emissions of pollutant particles, but also energy efficiency and robustness, reflected on longevity and lower number of technical assistance needed.

Our mission is increase the industrial productivity, protecting simultaneously the environment

All SETIMEP equipment are drawn and manufactured to offer to our clients, strength, reliability and lower energetic consumption.

We would like to invite you to explore our solutions of dedusting and industrial ventilation designed to comply with client specifications and answer the most diverse necessities and process variables from the most simple to the most demanding and technical.

Contact us! A professional team is available to work on your next project!

OTHER CHARACTERISTICS

- Easy assembly of the product (without welding at the installation place)
- Easy access to the filter bags
- Conceived to occupy the minimum space possible
- Instructions guide in Portuguese, Spanish, French and English
- CE Certificate of conformity



OPTIONS

- Version specially developed to be applied at explosive atmosphere (Version ATEX)
- Max level probe, type rotary 24Vdc (or other one);
- PT100 Probe to temperature control
- Differential Pressure Sensor
- Equipment Thermal isolation;
- Cover (For exterior filters)
- Hopper Electric Tracing
- "BY-PASS" to "OFF-LINE" working mode
- "BY-PASS" to "OFF-LINE" cleaning mode
- Hot air recirculation
- Several accessories (Platforms, extraction systems, additional instrumentation, etc.)

