



SETIMEP

Engenharia • Ambiente • Energia
Engineering • Environment • Energy

SILENCER CHIMNEY CAP

MODEL:
SET.PL.CHS.****



PRODUCT DESCRIPTION

Silencer Chimney Cap

AVAILABLE RANGE

Diameter from 300 to 1400mm (see annex table)

TYPE OF CONSTRUCTION

Welded Construction in structural carbon steel S235JR
(Manufacturing with specific dimensions and materials on request)

CODIFICATION / REFERENCE

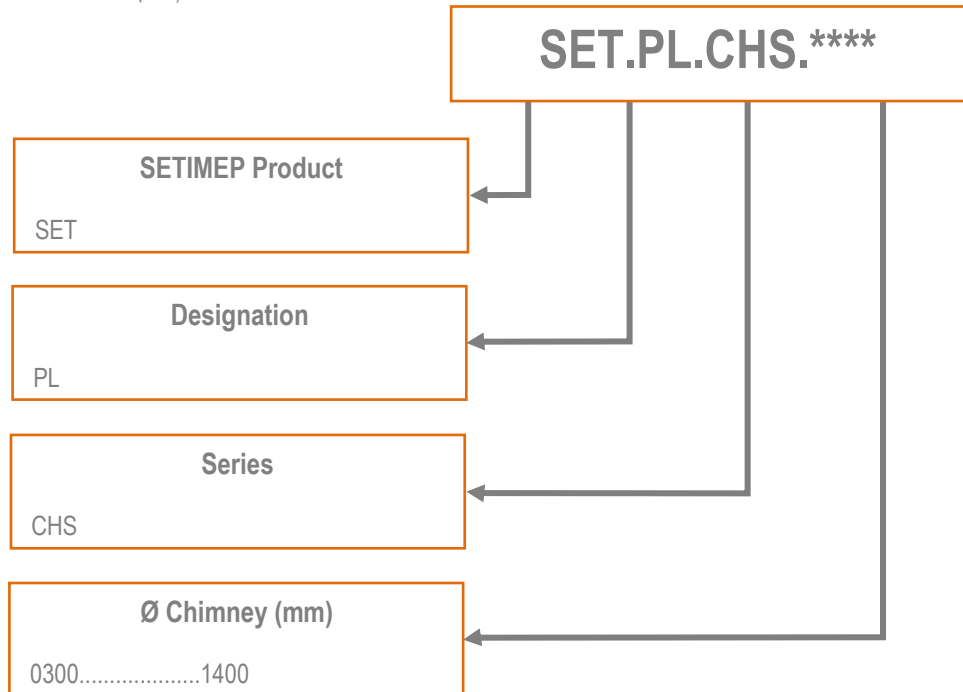
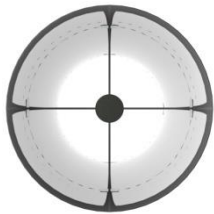

Ex: SET.PL.CHS.0350 →silencer chimney cap with Ø350mm

SILENCER CHIMNEY CAP

MODEL: SET.PL.CHS.****

Ød	L	Weight (kg)
300	840	31,98
350	940	39,23
400	1040	47,28
450	1140	55,90
500	1240	68,81
550	1340	79,81
600	1660	111,53
650	1760	124,34
700	1860	137,85
750	1960	152,45
800	2060	167,33
850	2160	182,90
900	2510	306,43
950	2610	332,03
1000	2710	358,68
1100	2910	434,88
1200	3110	496,85
1300	3310	562,94
1400	3510	633,17

Legend: Ø – Chimney Diameter; Ød1 - Cap Diameter; L – Cap Length.

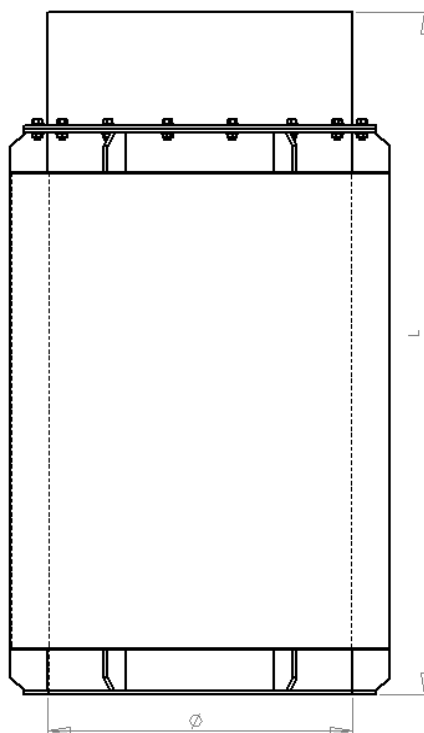

NOTES:

Product Available in the range and the specifications presented. (Manufacturing with others dimensions and materials on request).

It's not SETIMEP responsibility to ensure the Silencer Chimney Cap with other components. (Service on request).

The painting scheme is:

Blasting to SA 2,5 grade,

One coat of epoxy rich in zinc primer with approximately 60 µm.



SETIMEP, LDA

Rua Óscar Dias Pereira, 84 - Gualtar 4710-081 Braga | T. +351 253 679 469 | F. +351 253 679 478 | info@setimep.com | www.setimep.com

CAPITAL SOCIAL 50.000 EUROS, MATRICULADA NA CONSERVATÓRIA DO REGISTO COMERCIAL DE BRAGA, SOB Nº 6648 DFE 14/10/99, PESSOAL COL. Nº 503002780