



SETIMEP

Engenharia • Ambiente • Energia
Engineering • Environment • Energy

BICONIC CHIMNEY HAT

MODEL:
SET.PL.CHP.***



PRODUCT DESCRIPTION

Biconical hat for Chimneys

AVAILABLE RANGE

300 to 1400mm in diameter (See annex table)

TYPE OF CONSTRUCTION

Construction in structural carbon steel S235JR
(Manufacturing with specific dimensions and materials on request)

CODIFICATION / REFERENCE

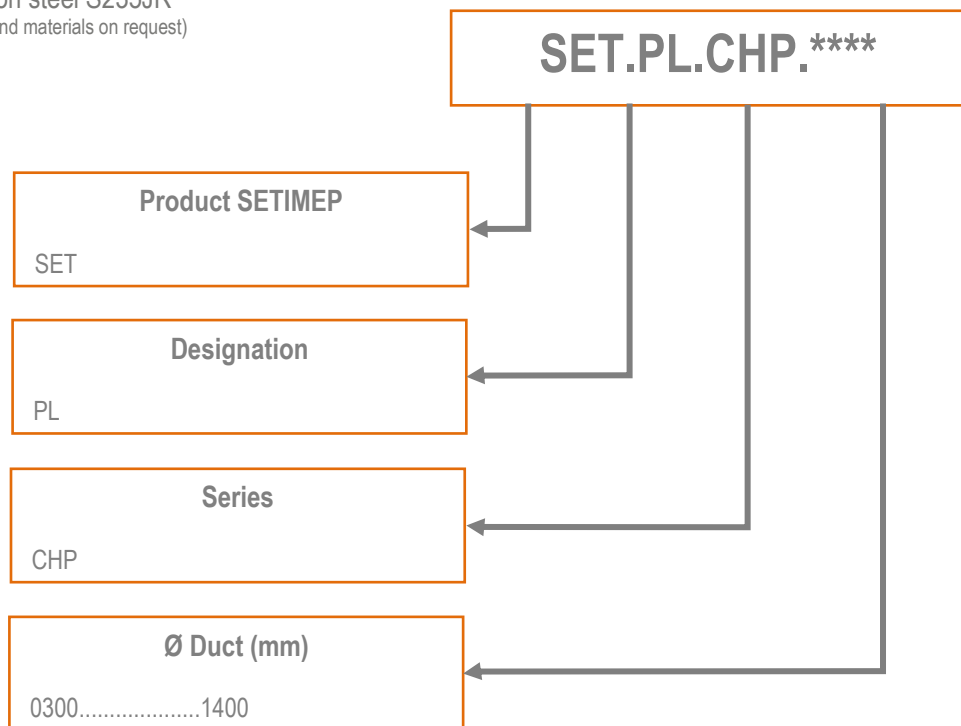

Ex: SET.PL.CHP.0350 → Biconical Hat for chimney with Ø350mm

BICONIC CHIMNEY HAT

MODEL: SET.PL.CHP.***

Ø	Ød1	Ød2	h1	h2	e	Weight (kg)
300	500	350	490	290	3	25,00
350	580	400	550	375	3	33,00
400	650	450	610	410	3	40,00
450	720	500	670	445	3	49,00
500	780	550	790	540	3	58,00
550	850	600	850	575	3	69,00
600	920	650	910	610	3	80,00
650	1000	700	970	645	3	94,00
700	1060	750	1080	730	3	106,00
750	1140	800	1150	775	3	122,00
800	1200	850	1210	810	3	133,00
850	1280	900	1270	845	3	150,00
900	1350	950	1390	940	3	174,00
950	1420	1000	1450	975	3	191,00
1000	1500	1050	1510	1010	3	210,00
1100	1640	1150	1650	1125	3	253,00
1200	1780	1250	1710	1160	3	287,00
1300	1920	1350	1790	1215	3	326,00
1400	2050	1450	1910	1310	3	370,00

Legend: Ø - Duct Diameter; Ød1 - Jet Cap diameter 1; Ød2 - Jet Cap diameter 2; h1 - Jet Cap total length; h2 - Jet Cap Length; e - thickness.

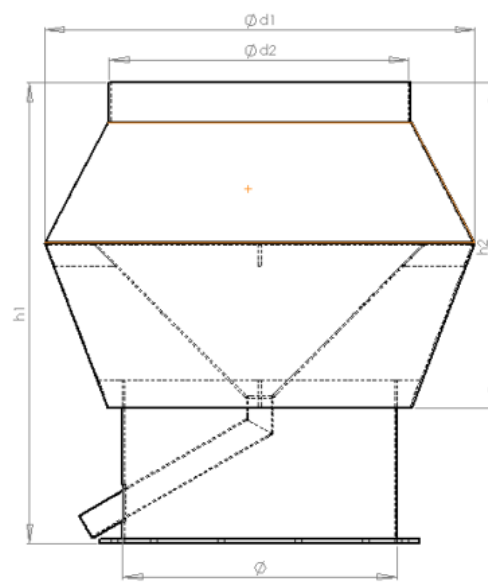
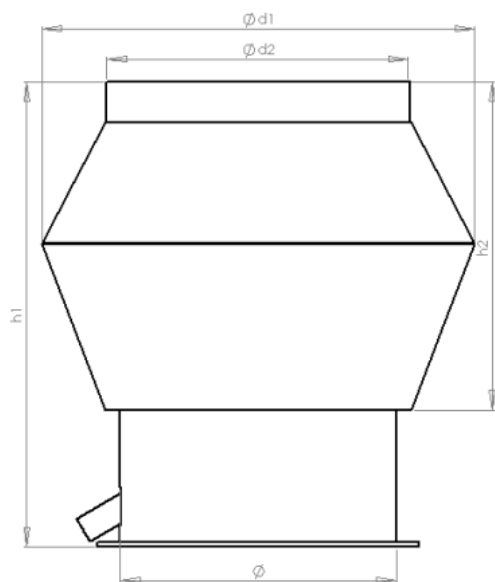

NOTES:

Product available in the range and specifications presented. (Manufacturing with specific dimensions and materials on request)

It's not SETIMEP responsibility to ensure the Jet Cap coupling with other components. (Service done on request)

The painting scheme is:

Blasting to Grade Sa 2,5.

One coat of epoxy rich in Zinc primer with approximately 60 µm thick.



SETIMEP, LDA

Rua Óscar Dias Pereira, 84 - Gualtar 4710-081 Braga | T. +351 253 679 469 | F. +351 253 679 478 | info@setimep.com | www.setimep.com

CAPITAL SOCIAL 50.000 EUROS, MATRICULADA NA CONSERVATÓRIA DO REGISTO COMERCIAL DE BRAGA, SOB Nº 6648 DFE 14/10/99, PESSOAL COL. Nº 503002780